

## PRODUCT DATA SHEET

### Product view



### Product information

QR Code



|               |                              |
|---------------|------------------------------|
| Product group | Wall Duct KG Bend            |
| Item number   | <b>CRA22176</b>              |
| EAN-Code      | 4260182347232                |
| Product name  | Wall Duct KG Bend DN 110 15° |

### Technical drawing

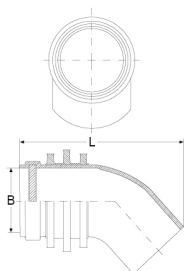

### Specification

|                           |            |
|---------------------------|------------|
| A   Outside-diameter (mm) | -          |
| B   Inside-diameter (mm)  | 110        |
| L   Angle (Degree)        | 15°        |
| Pressure (bar)            | 2.5        |
| Tightening torque (Nm)    | -          |
| Weight (kg)               | 0.4        |
| Material                  | PVC / EPDM |

### Product description

For the installation in waterproof concrete to connect HT/KG-pipes; form and pressure stable solid wall pipe; water pressure-tight, vulcanized Power-Profile to prevent ingress of odor, gas or water; one-sided connecting socket

### Certificates and approvals

|       |     |
|-------|-----|
| MPA   | Yes |
| CE    | -   |
| DIBT  | -   |
| SITAC | -   |
| ETA   | -   |

### Stable properties

|                                 |     |
|---------------------------------|-----|
| Heat-resistant (Celsius Degree) | -   |
| Cold-resistant (Celsius degree) | -   |
| UV-resistant                    | Yes |
| Ground-suited                   | Yes |
| Flush-mounting suited           | Yes |

