

PRODUCT DATA SHEET

Product view



Product information

QR Code



| | |
|---------------|------------------------------|
| Product group | Wall Duct KG Bend |
| Item number | CRA22177 |
| EAN-Code | 4260182347249 |
| Product name | Wall Duct KG Bend DN 110 30° |

Technical drawing

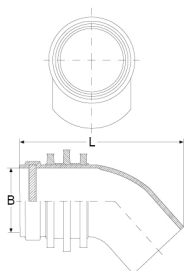

Specification

| | |
|---------------------------|------------|
| A Outside-diameter (mm) | - |
| B Inside-diameter (mm) | 110 |
| L Angle (Degree) | 30° |
| Pressure (bar) | 2.5 |
| Tightening torque (Nm) | - |
| Weight (kg) | 0.4 |
| Material | PVC / EPDM |

Product description

For the installation in waterproof concrete to connect HT/KG-pipes; form and pressure stable solid wall pipe; water pressure-tight, vulcanized Power-Profile to prevent ingress of odor, gas or water; one-sided connecting socket

Certificates and approvals

| | |
|-------|-----|
| MPA | Yes |
| CE | - |
| DIBT | - |
| SITAC | - |
| ETA | - |

Stable properties

| | |
|---------------------------------|-----|
| Heat-resistant (Celsius Degree) | - |
| Cold-resistant (Celsius degree) | - |
| UV-resistant | Yes |
| Ground-suited | Yes |
| Flush-mounting suited | Yes |

