

## PRODUCT DATA SHEET

### Product view



### Product information

QR Code



Product group	Wall Duct KG Bend
Item number	<b>CRA22189</b>
EAN-Code	4260182347362
Product name	Wall Duct KG Bend DN 250 30°

### Technical drawing

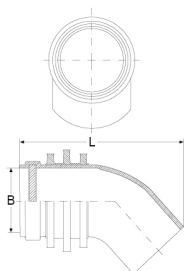

### Specification

A   Outside-diameter (mm)	-
B   Inside-diameter (mm)	250
L   Angle (Degree)	30°
Pressure (bar)	2.5
Tightening torque (Nm)	-
Weight (kg)	3.1
Material	PVC / EPDM

### Product description

For the installation in waterproof concrete to connect HT/KG-pipes; form and pressure stable solid wall pipe; water pressure-tight, vulcanized Power-Profile to prevent ingress of odor, gas or water; one-sided connecting socket

### Certificates and approvals

MPA	Yes
CE	-
DIBT	-
SITAC	-
ETA	-

### Stable properties

Heat-resistant (Celsius Degree)	-
Cold-resistant (Celsius degree)	-
UV-resistant	Yes
Ground-suited	Yes
Flush-mounting suited	Yes

