

PRODUCT DATA SHEET

Product view



Product information

QR Code



Product group	Wall Duct KG2000 Double Socket
Item number	CRA22198KG2
EAN-Code	4260391370137
Product name	Wall Duct KG2000 Double Socket DN 250

Technical drawing

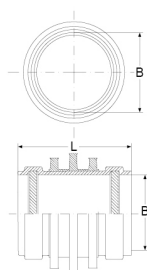

Specification

A Outside-diameter (mm)	-
B Inside-diameter (mm)	250
L Length (mm)	140
Pressure (bar)	2.5
Tightening torque (Nm)	-
Weight (kg)	2.9
Material	PP / EPDM

Product description

For the installation in waterproof concrete as feed-through for KG2000-pipes; form and pressure stable solid wall pipe; water pressure-tight, thermally bonded Power-Profile to prevent ingress of odor, gas or water

Certificates and approvals

MPA	Yes
CE	-
DIBT	-
SITAC	-
ETA	-

Stable properties

Heat-resistant (Celsius Degree)	-
Cold-resistant (Celsius degree)	-
UV-resistant	Yes
Ground-suited	Yes
Flush-mounting suited	Yes

