

## PRODUCT DATA SHEET

### Product view



### Product information

QR Code



Product group	Wall Duct KG2000 Double Socket
Item number	<b>CRA22200KG2</b>
EAN-Code	4260391370014
Product name	Wall Duct KG2000 Double Socket DN 400

### Technical drawing

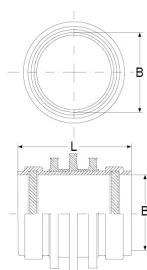

### Specification

A   Outside-diameter (mm)	-
B   Inside-diameter (mm)	400
L   Length (mm)	140
Pressure (bar)	2.5
Tightening torque (Nm)	-
Weight (kg)	7
Material	PP / EPDM

### Product description

For the installation in waterproof concrete as feed-through for KG2000-pipes; form and pressure stable solid wall pipe; water pressure-tight, thermally bonded Power-Profile to prevent ingress of odor, gas or water

### Certificates and approvals

MPA	Yes
CE	-
DIBT	-
SITAC	-
ETA	-

### Stable properties

Heat-resistant (Celsius Degree)	-
Cold-resistant (Celsius degree)	-
UV-resistant	Yes
Ground-suited	Yes
Flush-mounting suited	Yes

