



## PRODUCT DATA SHEET

### Product view



### Product information

Designation Inside End Cap CSV 114

Item number **CRA18625**

### Product description

Internal quick-release plug for sealing a piping system; suitable for permanent or temporary closure; wing nut for tightening; hollow screw also serves as a test connection for water pressure testing; suitable for horizontal or vertical installation; UV and weather-resistant material.

### Technical illustration

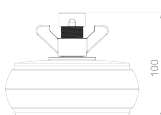
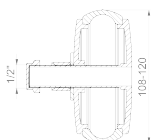

### Dimensioning

A | Size range 108-120 Inch

B | Test connection 1/2 Inch

L | Length 100 mm

### Specification

Pressure-tightness 0.5 bar / 7.3 PSI

Product-related standard EN 681-1

Weight 0.478 kg

Material EPDM, Aluminium

### Resistances

Temperature resistance -40 / 120 °C

UV resistant ✓

Suitable for soil ✓

Flush-mounting suited ✓

