



## PRODUCT DATA SHEET

### Product view



### Product information

Designation Drain Coupling CDC 050

Item number **CRA14023**

### Product description

External adapter for connecting two piping systems with the same pipe dimensions (DN), as well as for the same or different materials and surface structures; noise-reducing sealing lips; suitable for horizontal or vertical installation; suitable for use in plaster, concrete, and soil; UV and weather-resistant material.

### Technical illustration

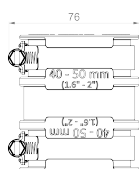
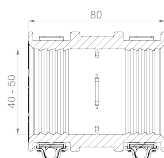

### Dimensioning

A | Size range 40-50 mm

L | Length 80 mm

### Specification

Pressure-tightness 0.6 bar / 8.7 PSI

Vacuum pressure tightness -0,3 bar

High-pressure flushing resistance 120 bar

Socket wrench insert SW 8 mm

Tightening torque 6,0 Nm

Angular deviation (max.) 5,0°

Insertion depth (min.) 25 mm

Product-related standard EN 681-1, EN 16397, EN 295-4

Weight 0.187 kg

Material EPDM, Stainless steel (AISI 304)

### Resistances

Temperature resistance -40 / 120 °C

UV resistant ✓

Suitable for soil ✓

Flush-mounting suited ✓

